



Hydrate Drinking Fountain Accessible Model 001

Heavy Duty, Stylish Drinking Fountain with Bubbler. Strong Fabricated Aluminum construction. Large Access Panel for ease of maintenance, Submerged Water Reservoir, High quality push button and Hygienic anti-bacterial spout, Wheelchair Accessible design.



Part of a range



Wheelchair access

Quality & durability

- Fully powder-coated, strong aluminum construction
- Hygienic anti-bacterial drinking spout
- Vandal resistant
- Push buttons supply flow of water

Important notes:

- The bubbler mechanism is inadvisable for temperatures consistently below 4°C, unless appropriate mitigation practices are implemented on-site.
- Fountain requires mains pressure to ensure optimal performance.
- If using a filter, it's recommended to be replaced every 6-12 months to prevent blockages that may result in insufficient pressure for the bubbler to function properly.
- It's crucial to maintain clean filters for the health and safety of users.

Ideal for

- Schools
- Council Parks
- Walkways
- Public Spaces

Finishes available

- Powder coated silver pearl (standard).
- Custom colour choice available (additional cost).

Specifications

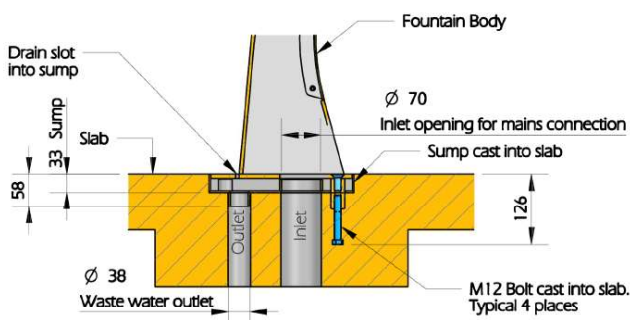
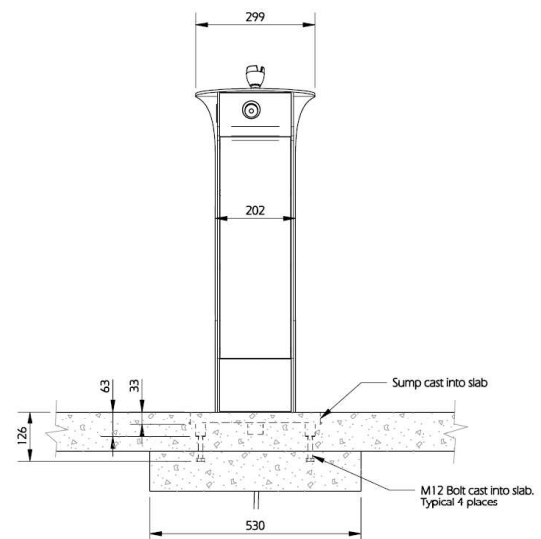
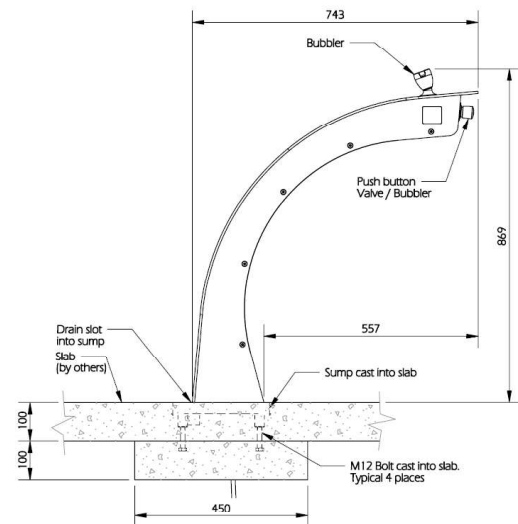

Contact us today

Freephone 0508 4 URBAN or visit urbaneffects.co.nz



Hydrate Drinking Fountain Accessible Model 002

Heavy Duty, Stylish Drinking Fountain with Bubbler and Bottle Filler. Strong Fabricated Aluminum construction. Large Access

Panel for ease of maintenance, Submerged Water Reservoir, High quality push button and Hygienic antibacterial spout, Wheelchair Accessible design



Part of a range



Wheelchair access

Quality & durability

- Fully powder-coated, strong aluminum construction
- Hygienic anti-bacterial drinking spout
- Vandal resistant
- Push buttons supply flow of water
- Bottle filler with vandal-resistant shroud filter

Important notes:

- The bubbler mechanism is inadvisable for temperatures consistently below 4°C, unless appropriate mitigation practices are implemented on-site.
- Fountain requires mains pressure to ensure optimal performance.
- If using a filter, it's recommended to be replaced every 6-12 months to prevent blockages that may result in insufficient pressure for the bubbler to function properly.
- It's crucial to maintain clean filters for the health and safety of users.

Ideal for

- Schools
- Council Parks
- Walkways
- Public Spaces

Finishes available

- Powder coated silver pearl (standard)
- Custom colour choice available (additional cost).

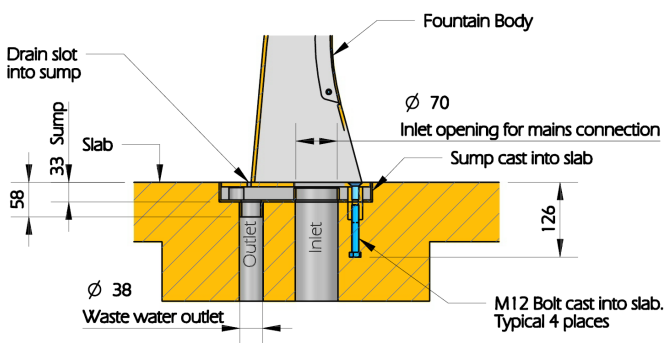

Specifications

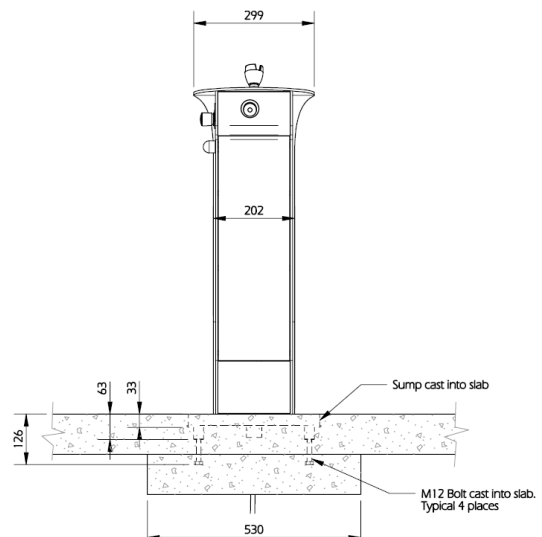
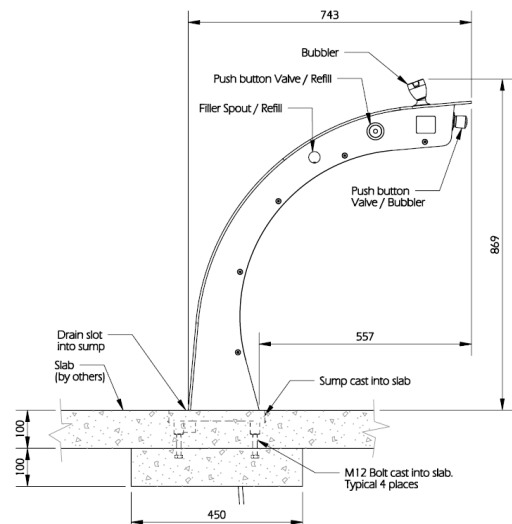

Contact us today

Freephone 0508 4 URBAN or visit urbaneffects.co.nz

Hydrate Drinking Fountain Accessible Model 004

Heavy Duty, Stylish Drinking Fountain Bubbler, Drink Bottle Filler and Dog Bowl. Strong Fabricated Aluminum construction. Large Access Panel for ease of maintenance, Submerged Water Reservoir. High quality push button and Hygienic anti-bacterial spout, Wheelchair Accessible design.



Part of a range



Wheelchair access

Quality & durability

- Fully powder-coated, strong aluminum construction
- Hygienic anti-bacterial drinking spout
- Dog Bowl
- Vandal resistant
- Push buttons supply flow of water
- Bottle filler with vandal-resistant shroud filter

Important notes:

- The bubbler mechanism is inadvisable for temperatures consistently below 4°C, unless appropriate mitigation practices are implemented on-site.
- Fountain requires mains pressure to ensure optimal performance.
- If using a filter, it's recommended to be replaced every 6-12 months to prevent blockages that may result in insufficient pressure for the bubbler to function properly.
- It's crucial to maintain clean filters for the health and safety of users.

Ideal for

- Schools
- Council Parks
- Walkways
- Public Spaces

Finishes available

- Powder coated silver pearl (standard)
- Custom colour choice available (additional cost).

Specifications

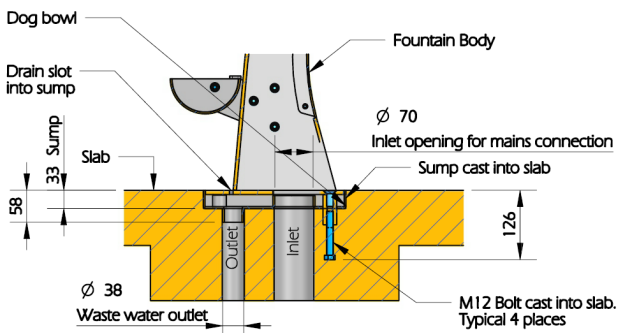
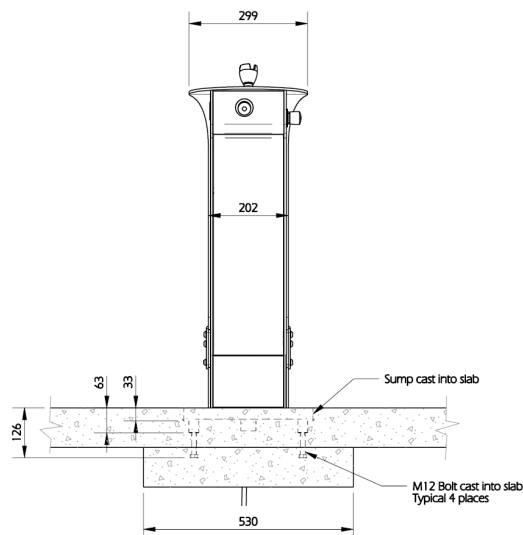
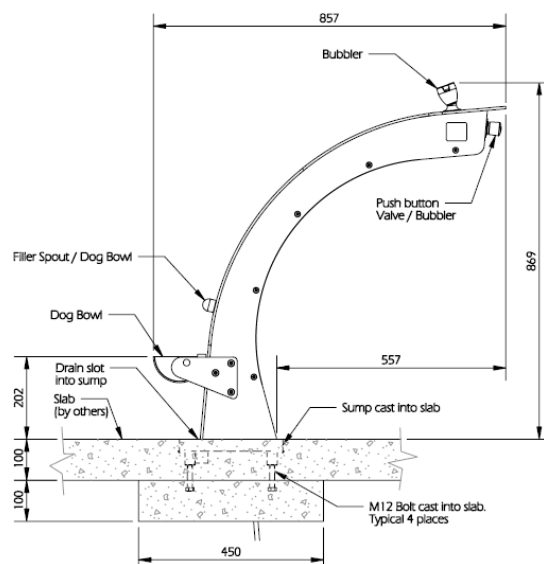

Contact us today

Freephone 0508 4 URBAN or visit urbaneffects.co.nz